

B

3 Bedroom
2.5 Bathroom

Interior 1,415 SF Outdoor 500-580 SF

Garage 623 SF

- 1 Large L-shaped kitchen with feature open shelving and a generous kitchen island.
- 2 Millworked closet off the kitchen for extra storage.
- 3 Indoor-outdoor living space extending from the kitchen.
- 4 Generous secondary bedrooms.
- 5 Tiled walls in ensuite bathrooms.
- 6 Millworked walk-through closet space in the primary bedroom.

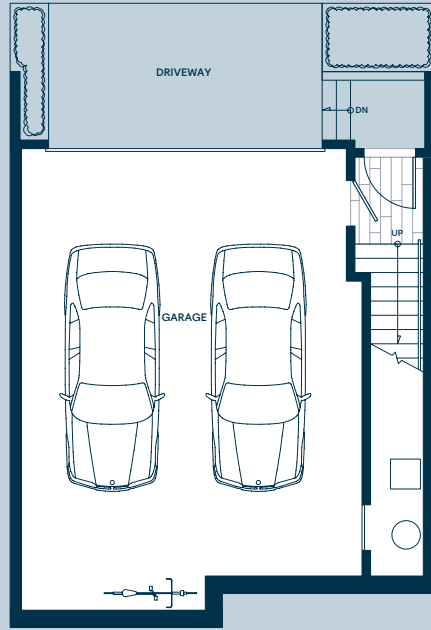
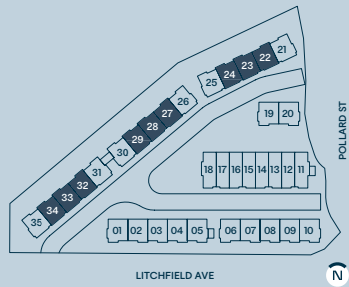

LOWER



MAIN

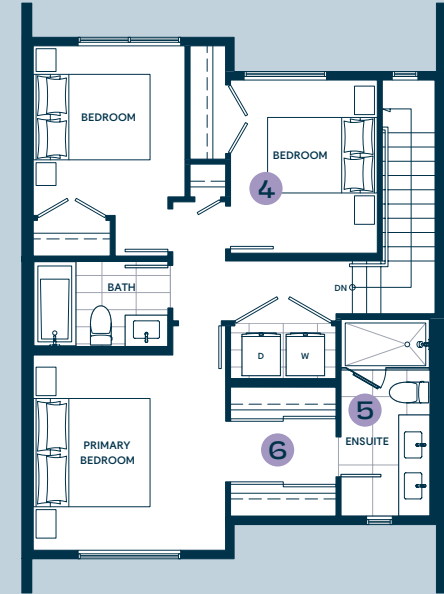

UPPER



TOWNS
AT BURKE

Developer reserves the right to make modifications to the floorplans, indoor & outdoor areas, unit numbers, and/or specifications without notice. Actual floorplans may be mirror image or have minor variations from the illustrations above. Views may include building architectural features/measurements are based on architectural areas and are not taken from the strata plan. This is not an offering for purchase. Any such offering can only be made with a Disclosure Statement. E&OE.